

# MAKE A COALPORT ROSE

Make a clay rose inspired by 'Coalbrookdale ware'. This type of pottery was decorated with handmade realistic clay flowers and was made at Coalport China Works between the 1820s and 1840s.

Women made the flowers using bone china clay. Bone china is a type of clay made with animal bones. When it is 'fired' or heated to a high temperature it becomes very hard and changes colour from light grey to white.

The flower-makers could make a rose in 30 seconds. This took a lot of practice so take your time!



Adult supervision required!

## You will need

- Clay. Most types of modelling clay or air dry clay will work very well. In the tutorial a lightweight clay was used. This type of clay air dries and does not require baking.
- You may need some water if you use clay-based airdry to smooth cracks. Use very little water as mushy clay may not hold the petal shapes!

## Instructions

Roll a ball of clay so that it is roughly 5cm (diameter). You can always use more clay if you need it.



Roll the ball into a long sausage shape. It is better to work a bit thicker to begin with. You can make balls of clay instead of working from one long piece of clay if it is easier for you.



Tap the clay to make it flat at one end. With your thumb squash the end of clay to flatten it into an oblong. Try to make it thinner towards the edge of the clay, keeping the rest thicker. Break off the rest of the clay (unless you are working from balls of clay).

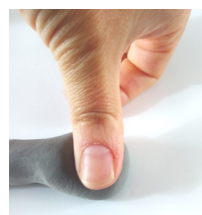

# MAKE A COALPORT ROSE

...Continued

Roll your flattened piece of clay into a spiral to make the centre of the rose.

Put it aside.



You will now make 3 petals using either balls of clay or the from the long piece of clay.

This time the clay needs to be in a rounded at the end.

Press down on edge of the clay in the centre. Then pat either side to make a disc of clay . This may take a bit of practice. Keep it thinner at the edges and thicker at the other end. This will help your petal to keep its shape.

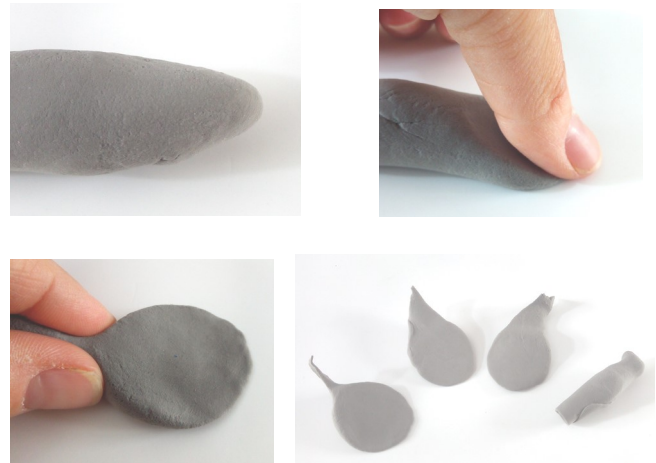

Starting with the spiral of clay add the petals around the outside. The petals need to be a little higher than the centre scroll.

Overlap the petals slightly. When they are all in place press them gently into the centre toward the spiral to make a realistic curved **rosebud**.



Using your thumb and forefinger gently curl the edges of each petal down.

Roll underneath the rosebud between your thumb and forefinger to make a stem. There should be some extra clay from making petals. You can always add some more clay if your stem is too short.



## Now try this

To create a bigger rose make 5 petals to put around the outside. You can also add leaves or sepals (the leaves just below the petals)

## Top tips

- Use the creases in your hands to make textures imprints on the petals.
- If you are using a clay-based airdry make your petals a little thicker and try to only flatten the very edges. It will help the petals to not crack and break when they dry.